

# 130 Series Single Function

- Recessed Mount
- ADR Road Approved
- IP67 100% Waterproof
- Voltage Range 12-24 Volt
- 5 Year Warranty

ADR  
Approved

100%  
Water Proof

5 Year  
Warranty

<b>Function</b>	(Stop/Tail) (Indicator)(Reverse)
<b>Size Grommet</b>	113mm x 160mm x 3mm
<b>Size Bracket</b>	109mm x 157mm x 3mm
<b>Voltage</b>	12-24 Volt
<b>LED Qty</b>	14 (White 32)
<b>Cable</b>	Plug 53102
<b>Lens</b>	Hardened Acrylic
<b>Mounting</b>	59401, 59401C, 59401B

<b>Draw</b>	<b>Stop</b>	<b>Tail</b>	<b>Ind</b>	<b>Rev</b>
@13.8V	0.23A	0.03A	0.20A	0.15A
@28V	0.12A	0.04A	0.14A	0.08A

<b>Approvals</b>	<b>Function</b>	<b>Category</b>	<b>CRN</b>
<b>ADR</b>	Stop/Tail	49/00	36844
<b>ADR</b>	Reflector	47/00	38102
<b>ADR</b>	Indicator	6/00 2a	36843
<b>ADR</b>	Reverse	1/00	36845
<b>CTA</b>	Stop/Tail/Ref	49/00, 47/00	CTA-060261
<b>CTA</b>	Indicator	6/00 2a	CTA-060233
<b>CTA</b>	Reverse	1/00	CTA-060300



Stop/Tail  
**130RMG** - Single Blister  
**130RMB** - Light Only Bulk



Rear Indicator  
**130AMG** - Single Blister  
**130AMB** - Light Only Bulk



Reverse  
**130WMG** - Single Blister  
**130WMB** - Light Only Bulk



Stop/Tail  
**130RMC** - Single Blister



Rear Indicator  
**130AMC** - Single Blister



Reverse  
**130WMC** - Single Blister

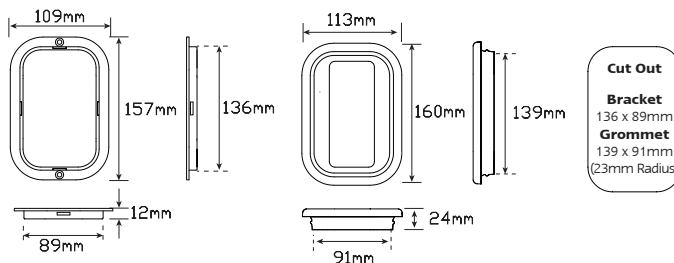

## Fitting Instructions

Retro fit lamps. If new installation, fit grommet or flange into cutout (cut out 139 x 91mm, 23mm radius), plug 53102 wire into lamp and run through back then push into grommet/flange. Please refer to ADR 13/00 for mounting instructions.



All enquiries P: (03) 9466 7075 E: led@ledtech.com.au, www.ledautolamps.com

All efforts are made to ensure all information is correct and up to date, it can be subject to change without notice. All measurements are in millimeters (mm) and are not to scale.

© All LED Technologies designs are registered throughout the world. - Current as of 30/11/2021